

**SPARX**  
Mobile

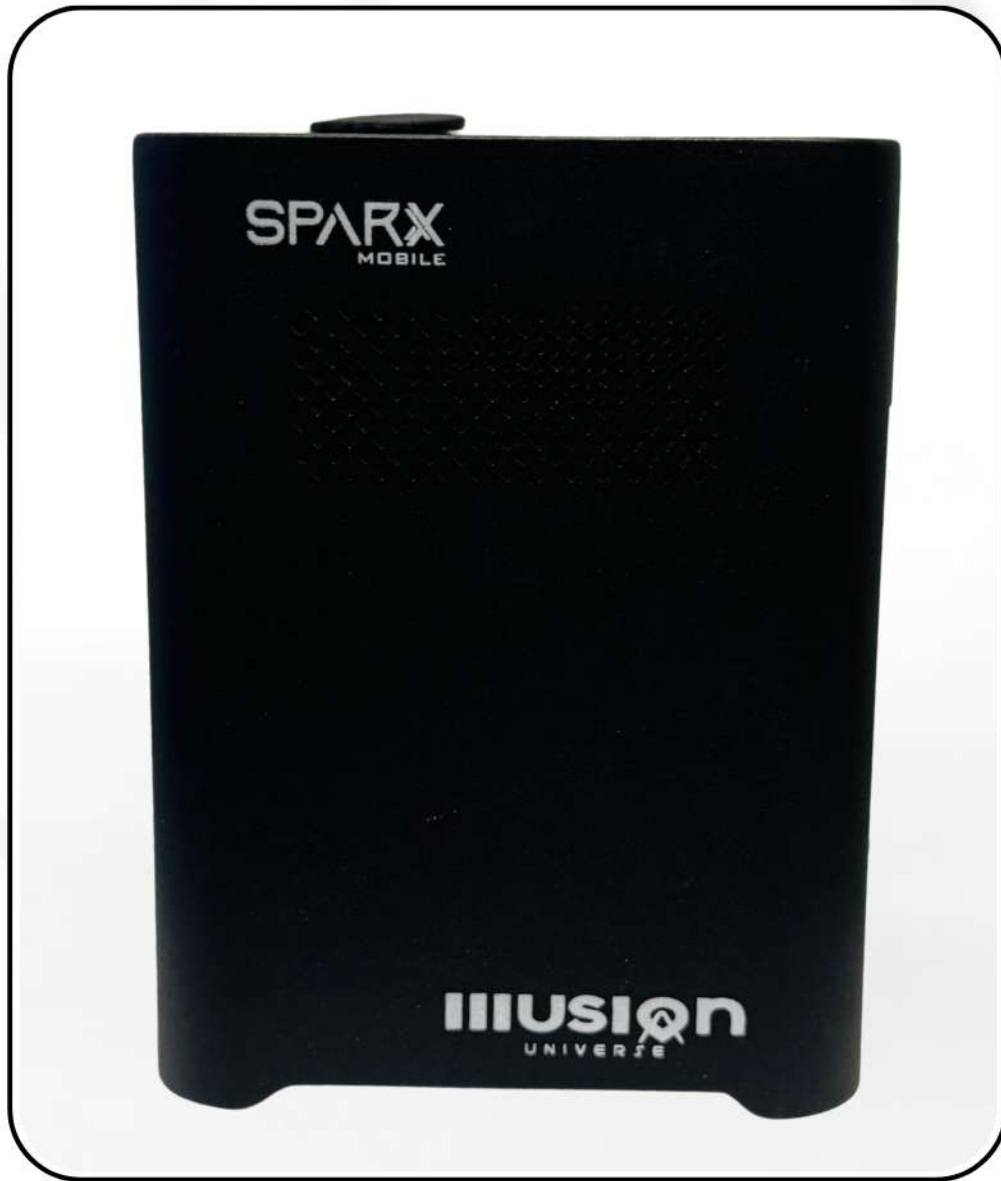

**SPARX MOBILE**

    / illusioncad

DESIGNED FOR CANADA 

**ILLUSION**  
UNIVERSE

 [www.illusionuniverse.ca](http://www.illusionuniverse.ca)

# User Manual

Model: BATTERY MINISPARK



Product Component Description					
1	Spray hole	4	Feeding hole	7	Power switch
2	Side handle	5	Cooling fan	8	Power port
3	Vent	6	Access hole	9	Vent
Product Parameters					
Charging time	2.5-3 hours	Fountain direction	Up		
Fountain height	2-3m	Control mode	Remote		
IN PUT	AC 100-240V 50/60Hz	Heating way	Resistance wire heating		
Gross Power (max)	400W	Housing material	Metal		
Power box capacity	70g	Size/N.W.	150 *150*200mm 2.5kgs		



	Battery Voltage	Battery level indicator
<b>Charging Status:</b>	<23.1V	Red light flashes slowly (Once per second)
	23.1V-24.5V	Red light always on + Green 1 flashes slowly
	24.5V-26.6V	Red light + Green 1 Always on + Green 2 flashes slowly
	26.6V-28.3V	Red light + Green 1 + Green 2 Always on + Green 3 flashes slowly
	>28.3V	Red light + Green 1 + Green 2 + Green 3 Always on ( Full Charge )
<b>Discharging Status:</b>	<20.5V	Low battery voltage protection Red light flashes quickly (Twice per second)
	20.5V-23.1V	Red light always on, low battery, please charge as soon as possible
	23.1V-24.5V	Red light + Green 1 Always on
	24.5V-26.6V	Red light + Green 1 + Green 2 are Always on
	>26.6V	Red light + Green 1 + Green 2 + Green 3 are Always on

## 1. Package Contents

### Included in delivery:

- 1 x cold spark machine;
- 1 x power cord;
- 1 x remote controller;
- 1 x user manual.

## 2. Indicator Description

**HEAT** : Red light      When the machine is heating, signal light is on.

**READY** : Green light      When the "READY" green light turns from flashing into light on, it indicates that the machine is ready to work.

**SLEEP**: Blue light      If there is no operation during the heating or ready state for more than 20 minutes, the machine will enter sleep mode.

**FAULT** : Yellow light      Fault indicator, indicating a device malfunction.

## 3. Remote Controller



**ON** : When the green light is flashing, press this button briefly to enter the heating state.

**OFF**: Press to turn off heating.

**Start**: Press to start spraying fireworks. Automatically stops if no operation within 22 seconds.

**Stop**: Press to stop spraying fireworks or stopping material cleaning.

**CLE**: Press to start material cleaning

## 4. Operation Instruction

When the machine Heated up will enter self-test mode. The blower will run for about 1 second. If the green light flashes, it indicates that the machine is not faulty and is in standby mode. At this point, press the ON button to enter heating mode. The red light will always on display, and the heating will last for about 3 to 5 minutes. The green light will always on display, (It is better to wait for 1 minute before spraying) indicating that the heating is complete and the machine is ready. Press the start button to start spraying sparks upwards, and the spraying will automatically pause for 22 seconds upon completion. You can also stop spraying by pressing the stop button. After using the machine, press the CLE button to clean the materials.

**(Please see pages 8-9 for simple steps)**

## 5. Consumables

### 1) The consumables are classified as:

SMALL: the spark fountain height 2-3m, and the spot is rarely dropped,use for indoor.

LARGE: It is forbidden to use outdoor powder, which will cause material jamming and poor spraying effect due to temperature.

### 2) Consumables choice:

Consumables are the customized formula for the test of our machines. Please select our consumables to avoid affecting the effect of the machine; (No warranty service is provided for machines damage caused by consumables not from our company).

### 3) Consumables save:

Consumables should be kept in a dry and sealed environment to prevent moisture.(wet and sundry consumables should not be used).

### 4) Consumables add:

Please stop running the machines before add the consumables, to avoid accidental injury.

## 6. Clean and Maintenance

**1) Cleaning function:** Must do clean Powder after each events used, avoid be stuck by inside powder for next use. The residual power of screw rod can be automatically cleaned by remote controller.

**Operation step:** Firstly empty the remaining powder in the material box, and then press the clear button until no sparks are ejected.

If you need to save the equipment, please pour out the remaining powder inside for separate storage after cleaning, avoid to affect the next use of the remaining powder affected by moisture.

**2) External cleaning:** Please wipe the machine gently with soft cotton, to avoid scratch the machine housing.

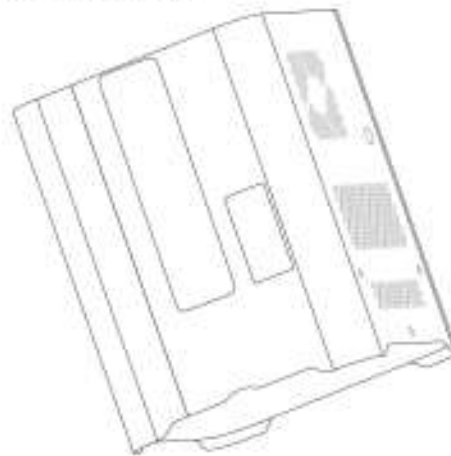

**3) Heat dissipation:** Clean the residual powder and stop heating before storing the machine, keeping the machine power on with 5 minutes to remove the internal heat by fan.

## 7. After-sales

**1) Warranty:** 6 months (Subject to the date of manufacture).

**2)** Each machine is affixed with the factory code. The factory code shall be provided when enjoying the warranty service. It is invalid if torn. It's may need provide some videos or pictures to confirm the problems.

## 8. Warnings and Cautions

	<p>Above: Feeding hole Below: Spray hole</p>
	<p>The sign is to remind users of paying attention to risk and security. Please note that the machines are not meant to be a continuous duration effect. The maximum running time is 22 seconds and can be repeated but should not be done to overheat the machine.</p>
	<p>Eye protection warning sign is to remind you of protecting the eyes during the machine operation.</p>
	<p>Warning: Dangerous voltages are present in this machine when electrical power is applied. There is a danger of injury from electric shock. Under no circumstances are you to attempt to open the machine or attempt to remove or adjust any components fitted within the machine. Only fully trained engineers can open the equipment.</p>
	<p>Use caution so that any liquids do not wet the machine. Keep the machine and controller dry and not use rainy or snowy days unless covered.</p>
<p><b>Cleaning</b></p>	<p>Please check the spark nozzle before use to confirm if there are any accumulated particles. If there is, please invert the machine to the cleaning port for cleaning.</p>

- 1)** The machine is equipped with a built-in protection program, which will automatically stop when the spark spraying time exceeds 22 seconds. If it needs to work again, please operate it again. If the continuous spraying time is too long, the internal temperature will rise sharply, causing permanent damage. It is recommended not to use it continuously for more than 1 minute.
- 2)** No in/out ports, cannot be series connection.
- 3)** If there is no spark out with enough consumables or other abnormal situation, please stop running machine and contact after-sale service for help.
- 4)** After use the machines, do not immediately turn off the power. The heat-dissipating fan should take out the internal air when the power is on. Otherwise, the internal heat is quickly transmitted to the surface of housing.
- 5)** Please place the equipment in an open place and keep a safe distance of more than 5 meters from the personnel.
- 6)** Make sure the device is off before filling the consumables.
- 7)** If the consumables are accidentally ignited, please use the sand to extinguish, do not use water.
- 8)** Damage caused by improper use or human factors is not covered by the warranty.

## Usage steps



④ Press the "ON" button

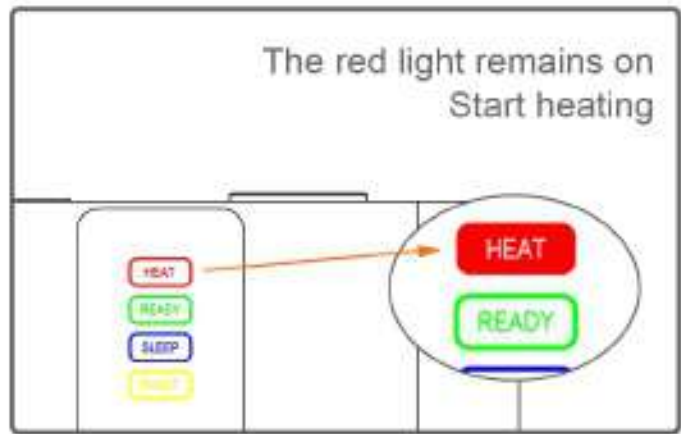

⑤

Wait for 4-5 minutes  
Until steady green light

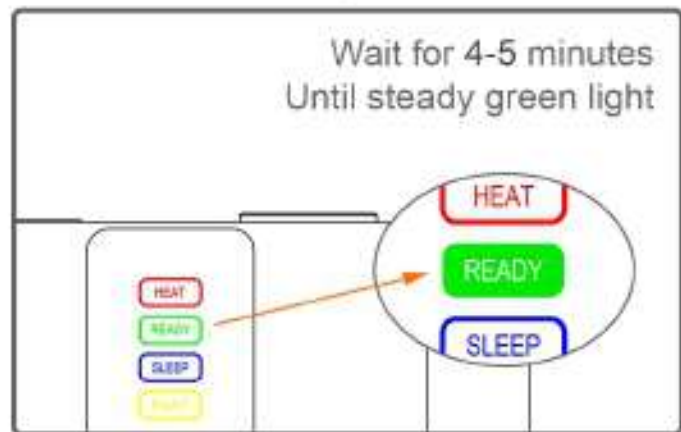

Press the "Start" button



⑥

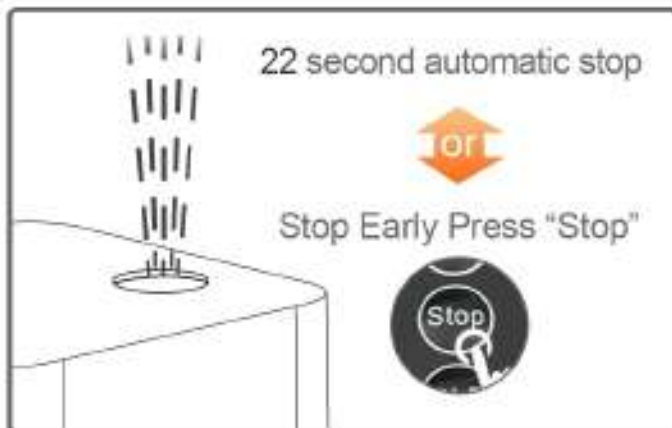

Press the "CLE" button\*



⑦

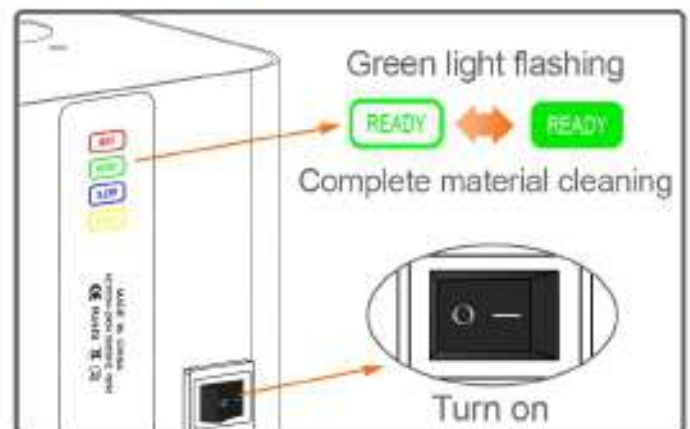

(\* : Press the "CLE" button after usage to make sure no powder remains inside to cause possible damage. )



# Contact Us

---



SALES@ILLUSIONUNIVERSE.CA



UNIT 11, 10 FALCONER DRIVE,  
MISSISSAUGA , ONTARIO, CANADA



WWW.ILLUSIONUNIVERSE.CA